



PUMPSET CERT. NO. : 20190411-MH63401
 PUMP CERT. NO. : 20180802-MP5163
 STRAINERS CERT. NO. : 20170721-MP5156
 OVERFILL PROTECTION DEVICES
 CAN/ULC-S661-10

NOTE : This drawing and the information depicted therein is the property of Albany Pump Co. Ltd. Copies are issued in strict confidence and shall not be reproduced, copied or used as the basis for the manufacture or sale of products without prior written permission of Albany Pump Co.

OPERATING CONDITIONS

Maximum Pressure	150 PSI
Float Material	316 SS
Stem Material	316 SS
Operating Temperature	-20F ~ 210F
Max. Operating Temperature	125°C / 257°F
Resolution	240
Accuracy	1,0
Output Type	4-20mA

ELECTRICAL CONNECTION:

Red Wire = Signal
 Black Wire = Negative Voltage
 (Loop Powered 10-30 VDC)

RATING:

Housing	Nema 4X, Explosion Proof, Class 1, Div 1, Group B, C & D
Switch	Class1, Div 1, Group A
Switch Certified To	CAN/CSA STD. C22.2 NO. 1010-1 CAN/CSA STD. C22.2 NO. 30
Conforms To	UL1203 & ANSI/ISA S82-03

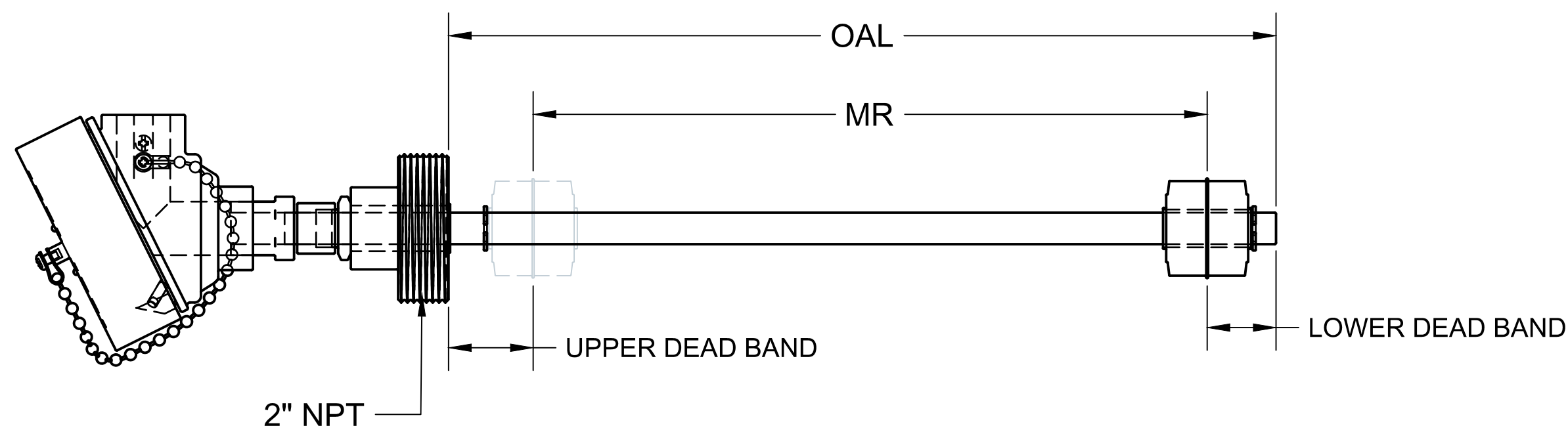
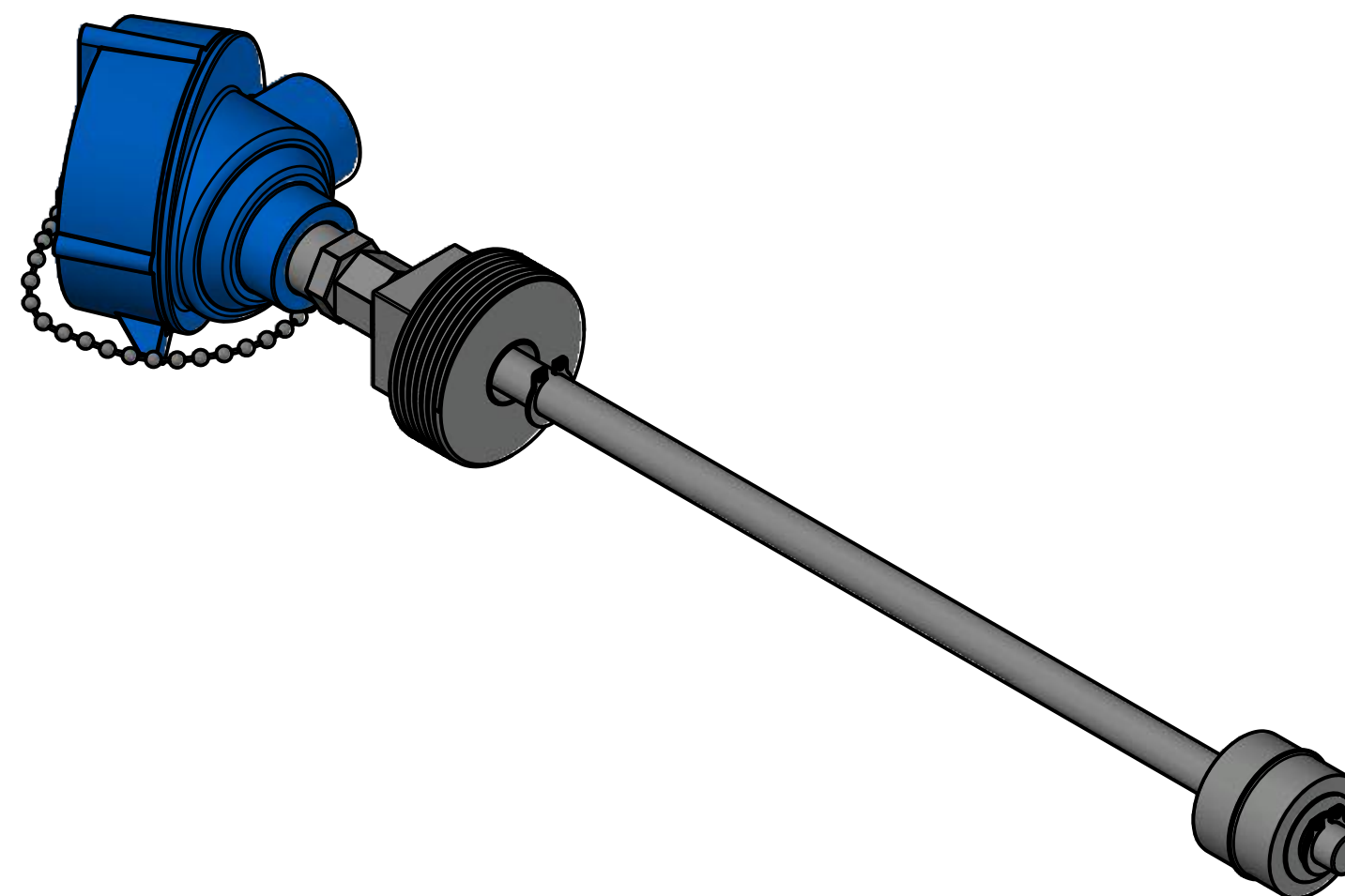

MANUFACTURING HEADQUARTER:
 420 Harry Walker pkwy. Newmarket,
 Ontario Canada, L3Y 8P5
Sales Office:
 Burnaby, B.C. (Canada)
 Buffalo, New York, (USA)
 Phone: (905) 853-9005
 Toll Free: 1 (888) 334-3348
 Fax: (888) 335-3391
 E-mail: sales@albanyump.com
 www.albanyump.com

LEVCON - CLT

TAG :
LEVEL SWITCH

DRAWN :
VP

MODEL :
LEVCON

SCALE :
1:2

FUNCTION	CONTINUOUS LEVEL
MEASURING RANGE	MR
OVERALL LENGTH	OAL
UPPER DEAD BAND	1" (minimum)
LOWER DEAD BAND	1" (minimum)