



PUMPSET CERT. NO. : 20190411-MH63401
 PUMP CERT. NO. : 20180802-MP5163
 STRAINERS CERT. NO. : 20170721-MP5156
 OVERFILL PROTECTION DEVICES
 CAN/ULC-S661-10

NOTE : This drawing and the information depicted therein is the property of Albany Pump Co. Ltd. Copies are issued in strict confidence and shall not be reproduced, copied or used as the basis for the manufacture or sale of products without prior written permission of Albany Pump Co.

OPERATING CONDITIONS

Maximum Switching Voltage VOLTS DC/AC	240
Maximum Switching Current AMPS DC/AC	1.0
Maximum Switching Power WATTS DC/AC	50
Maximum Pressure	150 PSI
Float Material	316 SS
Stem Material	316 SS
Operating Temperature	-40F ~ 250F
Max. Operating Temperature	125°C 257°F

RATING:

Housing	Nema 4X, Explosion Proof, Class 1, Div 1, Group B, C & D
Switch	Class1, Div 1, Group A
Switch Certified To	CAN/CSA STD. C22.2 NO. 1010-1 CAN/CSA STD. C22.2 NO. 30
Conforms To	UL1203 & ANSI/ISA S82-03



MANUFACTURING HEADQUARTER:
 420 Harry Walker pkwy. Newmarket,
 Ontario Canada, L3Y 8P5
Sales Office:
 Burnaby, B.C. (Canada)
 Buffalo, New York, (USA)
 Phone: (905) 853-9005
 Toll Free: 1 (888) 334-3348
 Fax: (888) 335-3391
 E-mail: sales@albanyump.com
 www.albanyump.com

LEVCON - LC800

TAG :
LEVEL SWITCH

DRAWN :
VP

MODEL :
LEVCON - 4

SCALE :
1:4

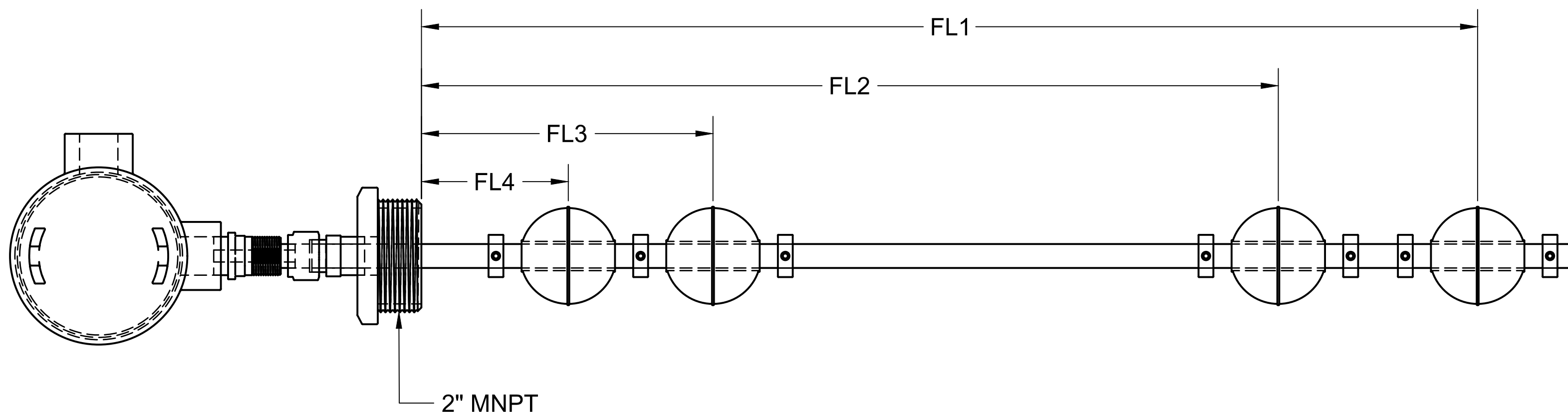
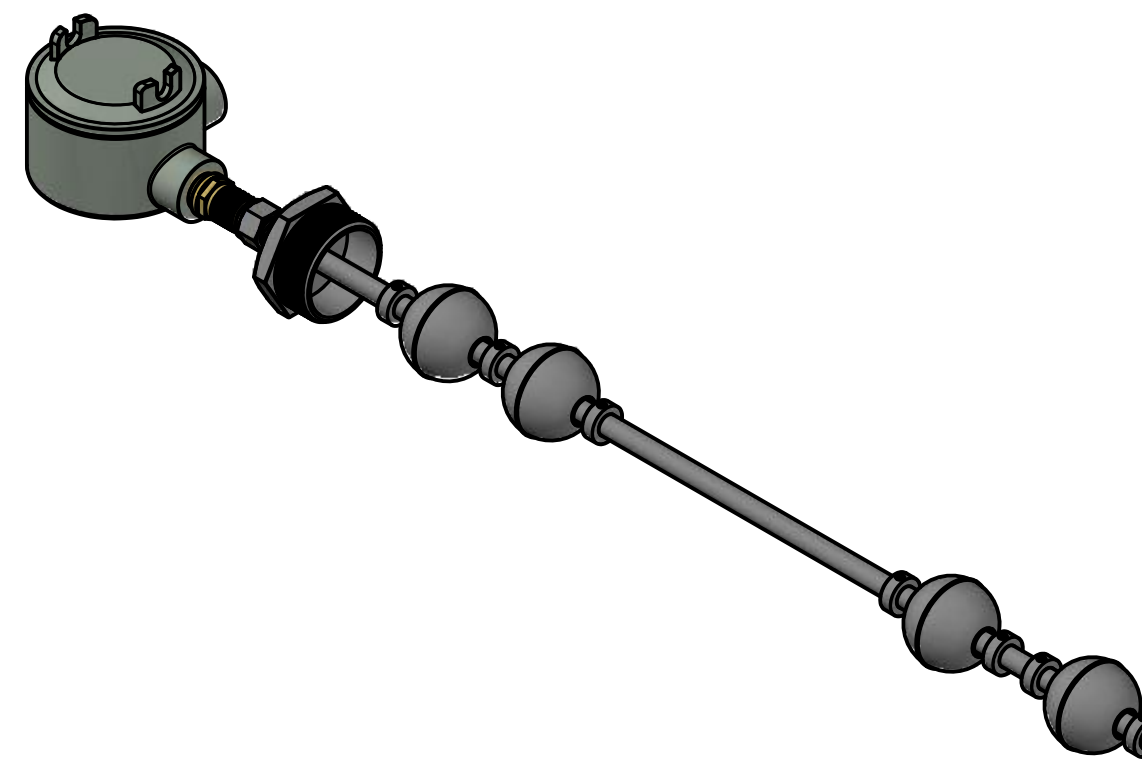

FLOAT LEVEL	FL1	FL2	FL3	FL4
FUNCTION	LOW LEVEL ALARM	START LEAD PUMP	STOP ALL PUMPS	HIGH LEVEL ALARM
HEIGHT FROM TOP OF TANK (% OF TANK VOLUME)	35%	50%	85%	90%
NORMALLY OPEN (NO) / NORMALLY CLOSED (NC)	NC	NC	NC	NC
WIRE COLOUR	BROWN	BLUE	GREEN	RED