

ROTARY HAND PUMPS – SRWP K SERIES

SRWP K Series pumps are suitable for the handling of clear and light liquids such as water, petrol, diesel and all fuels, paraffin, alcohol, light chemical solutions, edible oils etc. and are the only hand pumps safe for use with very hot liquids – up to 80°C (176°F).

APPLICATIONS

- Fuel Oil Transfer
- Water Well Pump
- Barrel Transfer Pump
- Manual Back up Pump
- Bilge Pump

DELIVERY: 0-19 USGPM | Based on 60 twin strokes per minute.

SUCTION: 30 PSI Discharge | 20 Ft.



FEATURES

- Semi-rotating. The lever has an alternating mechanism, and operating strain is minimal
 - Dual effect. The pump runs during both movements of the lever.
 - Self Priming. The pump's outstanding construction ensures perfect self-priming
 - Suction and force operations
 - Large head. Suction is guaranteed up to 20 feet, delivery up to 65 feet.
 - Suitable for clear water, lubricating oil, diesel fuel, and oil.
- Construction : Cast Iron frame, inner parts of bronze and light alloy.

DIMENSIONS

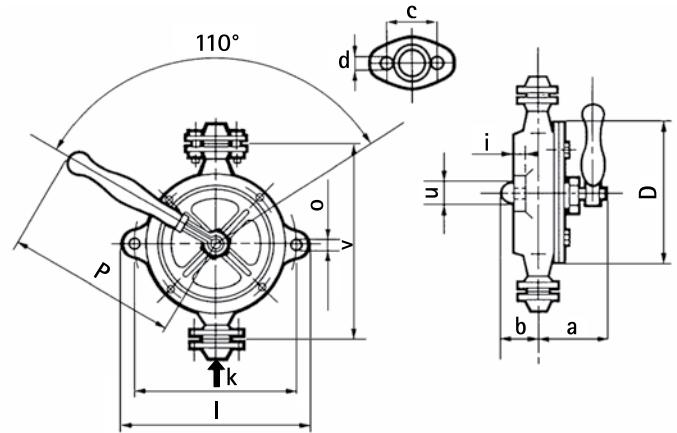

GENERAL INFORMATION - STANDARD MODEL

Type	K-00	K-0	K-1	K-2	K-3	K-4	K-5	K-7
Size in Inches	3/8"	1/2"	3/4"	1"	1 1/4"	1 1/4"	1 1/2"	2"
Weight* kg	3.2	5.1	6.1	8.8	11.5	12.6	16	32
Weight* Lbs	7.0	11.2	13.4	19.4	25.4	27.8	35.3	70.5
Double strokes* (per min)	80	65	60	55	50	50	45	40
Capacity LPM	7.5	11.5	17.25	22.5	29	43.25	53.5	90
Capacity GPM	1.65	2.5	3.75	5	6.5	9.5	11.75	19.8
Max Delivery Head (m)	25	25	25	25	22	22	20	15
Max Delivery Head (feet)	82	82	82	82	72	72	66	49
Pieces per case	30	30	25	15	10	8	6	3
Weight per case (gross)	117	174	174	153	136	122	117	116
Weight per case (net)	96	153	153	132	115	101	96	95

Size	K-00	K-0	K-1	K-2	K-3	K-4	K-5	K-7
D	100	135	150	170	200	220	245	288
a	90	140	140	145	170	190	200	273
b	45	55	55	60	62	74	76	72
i	7.5	10	10	10	12	12	12	15
k	98	130	150	170	200	220	240	310
v	110	175	205	230	275	295	320	360
l	120	160	180	200	240	255	275	360
o	7	13	13	13	13	13	13	15
p	220	300	300	360	450	500	600	620
u	32	25	25	30	30	30	35	50
c	-	55	65	75	90	90	100	100
d	-	9.5	9.5	9.5	14	14	14	15
In/Out BSP	3/8"	1/2"	3/4"	1"	1 1/4"	1 1/4"	1 1/2"	2"

Dimensions in mm

* this data is approximate

Suction lift – 7m for all sizes

For prolonged use at depth below 3m, a foot valve should be fitted.